

**SYMBOLS KEY:**

- Sign location (entrance and/or directional sign)
- Special Feature
- Formalized path
- Rustic trail
- Shade tree
- Woodland
- Herbaceous plantings
- Lawn area
- Fence
- Picnic table

**PLAN FEATURES:**

1. Parking lot improved to add full aisle width and lighting
2. Relocate entrance kiosk to head of trail and parking lot; Add plantings; Align walkway and crossing to picnic area
3. Improve accessible parking; Add curb and paved walk, bicycle rack, plantings, and post light
4. Realign pathway away from maintenance building
5. Paint maintenance building a color to reduce visual impact
6. Improve entrance walk into picnic and performance space; Pave path segments to performance stage
7. Reroute path behind performance area; Discontinue former path segment through wetland setback; Expand trail pavement to edge of existing shoulder (7' avg.) from entrance to approximately 45 linear feet east of the cisterns where relocated trail segment aligns with existing trail
8. Replace / upgrade existing pipe handrails along path
9. Naturalize drainage area with native plantings; Replace / upgrade crossing
10. Improve existing overlook; Replace/upgrade existing guardrail, seating, and interpretive signage; Supplement with native plantings
11. Manage invasive species along path edges and replace with native plantings, where appropriate (future project)
12. Discontinue path and footbridge segment at cisterns; Maintain access to existing overlook; Shift interpretive sign location
13. Reroute path away from ravine and layout to reduce slope;
14. Improve existing trail head with a new kiosk, signage, and landscaping (future phase)

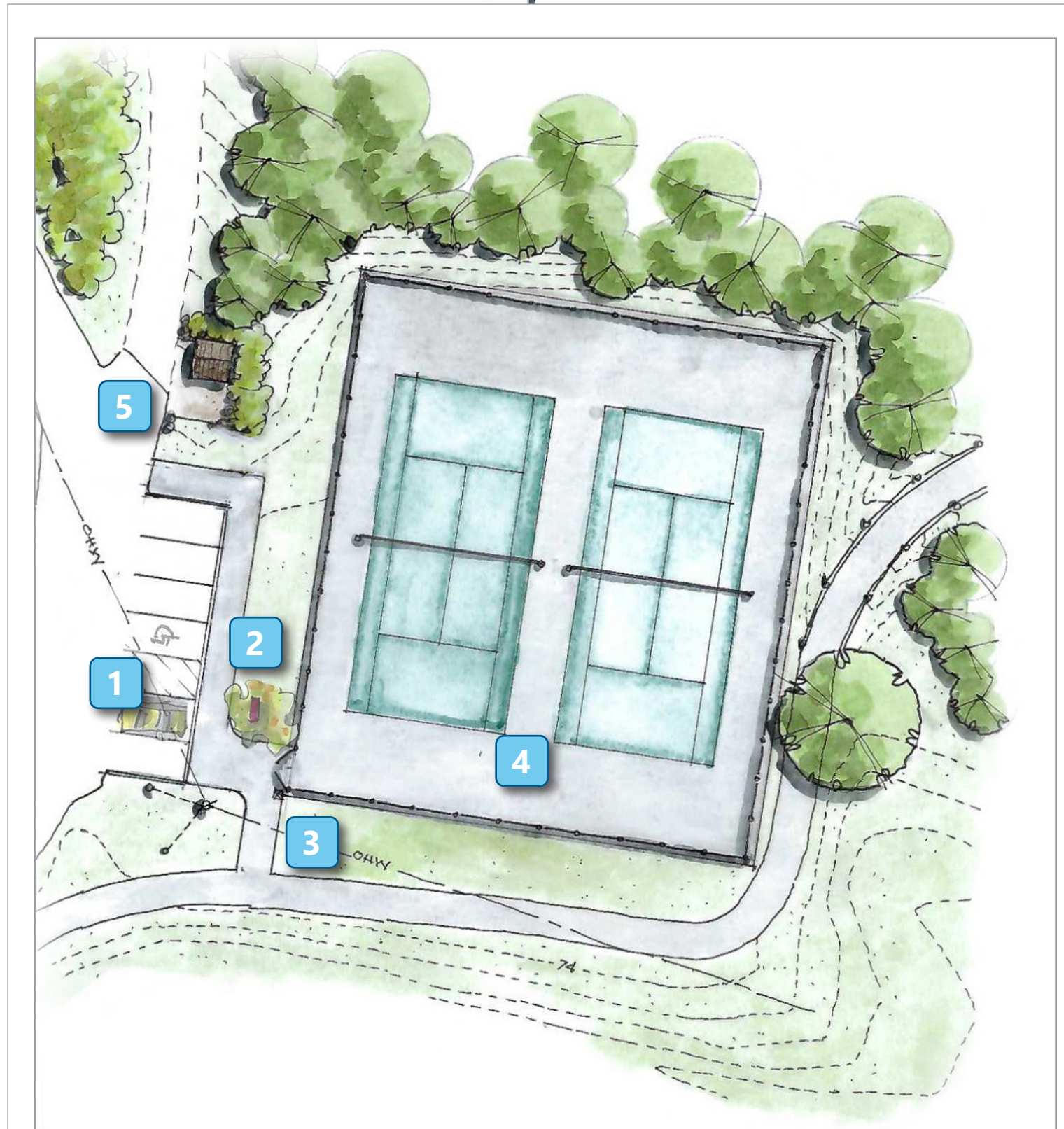

**TENNIS COURTS**

**TENNIS COURT PLAN FEATURES:**

1. Improve existing parking area and align accessible spaces with new sidewalk / accessible route (future phase)
2. Entrance sign and plantings at realigned gate entrance; double gate for service access (future phase)
3. Connect new sidewalk to Beth Condon Trail (future phase)
4. Reconstruct existing tennis courts and replace / upgrade existing chain link fence
5. New kiosk and trail entrance with signage and landscaping (future phase)

**ROYAL RIVER PARK SITE**

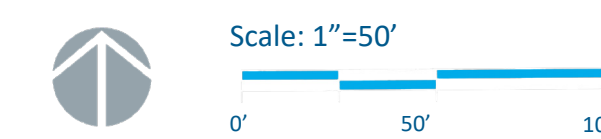

Date: May 27, 2021; Revised April 1, 2026

Consultant Team:



# ROYAL RIVER PARK IMPROVEMENTS CONCEPT PLAN

Prepared for:



Town of Yarmouth  
200 Main Street  
Yarmouth, ME 04096